

TLOCRT

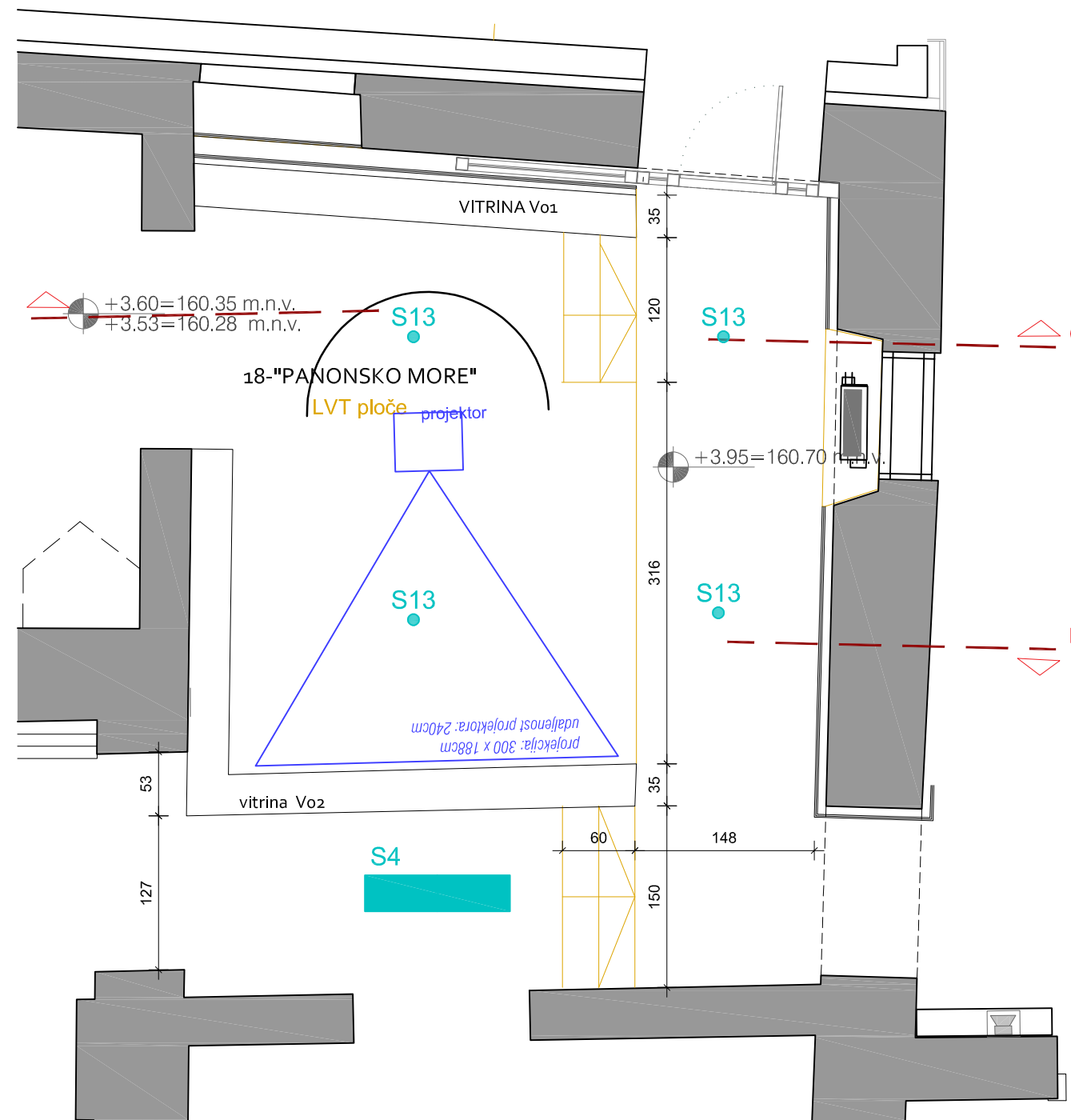

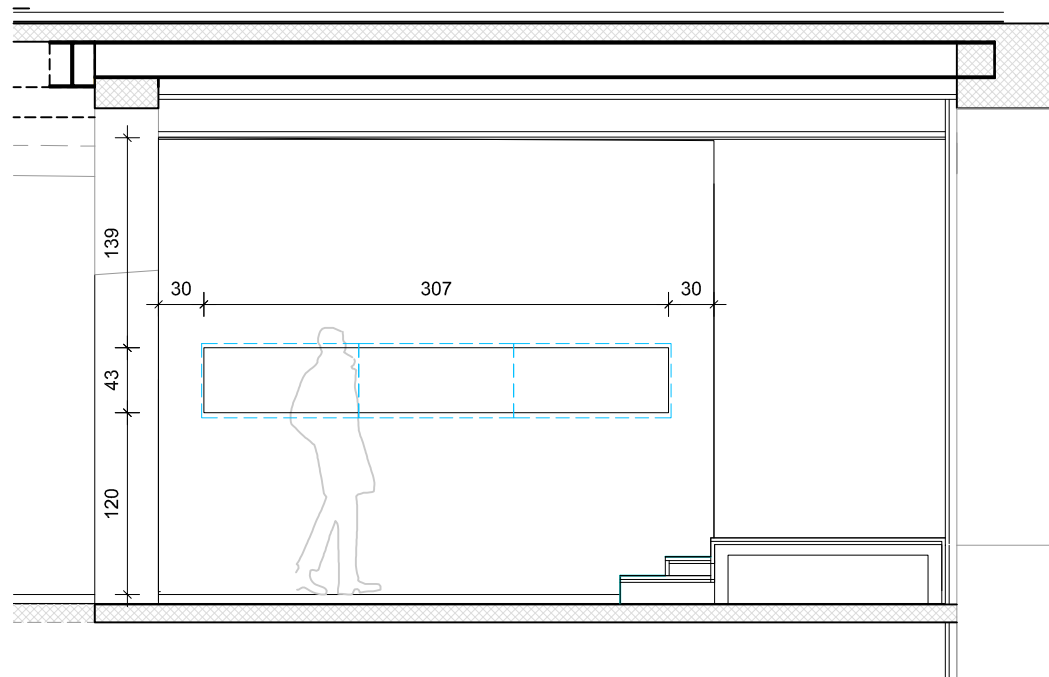

PRESJEK C-C

V01_ / Panonsko

Materijal: MDF 18mm (matirani lak), staklo

Polica u vitrini: Laminirano staklo 6-8mm debljine, dimenzije površina: A 520x35cm, B 220x35cm

LED traka dužine 370cm (topla, 3000K)

Okovi za otvaranje staklenih vratašca - 8 vrata, vrata se otvaraju prema gore

V02_ / Panonsko

Materijal: MDF 18mm (matirani lak), staklo

Polica u vitrini: Laminirano staklo 6-8mm debljine, dimenzije površina: A 520x35cm, B 220x35cm visina vitrine 250cm

LED traka dužine 370cm (topla, 3000K)

Okovi za otvaranje staklenih vratašca - 8 vrata, vrata se otvaraju prema gore

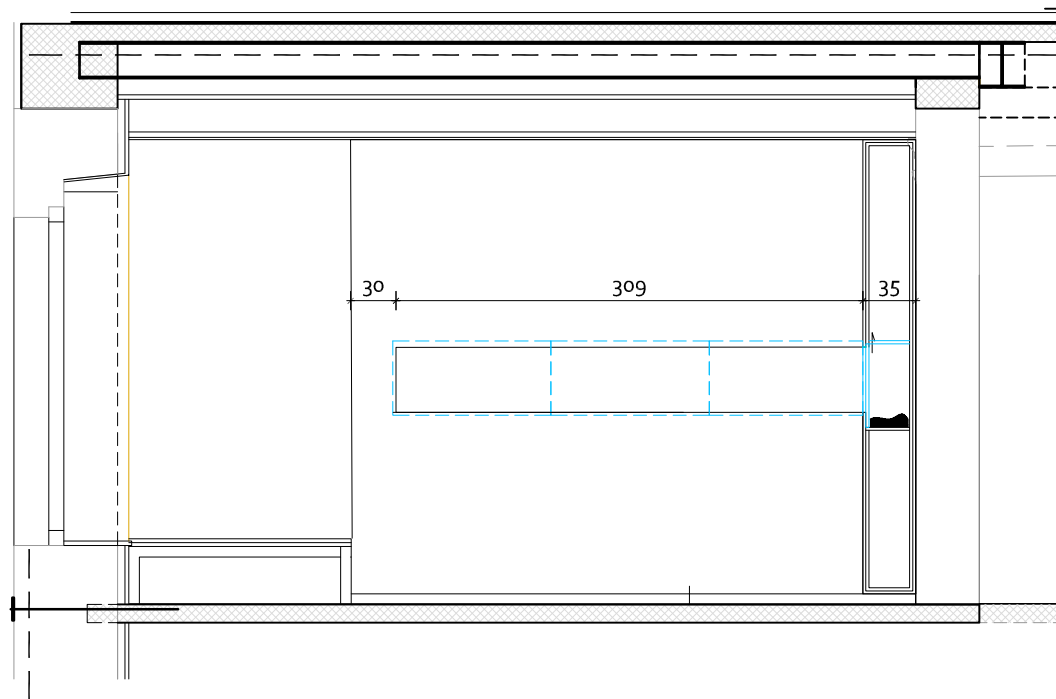

PRESJEK B-B

TLOCRT

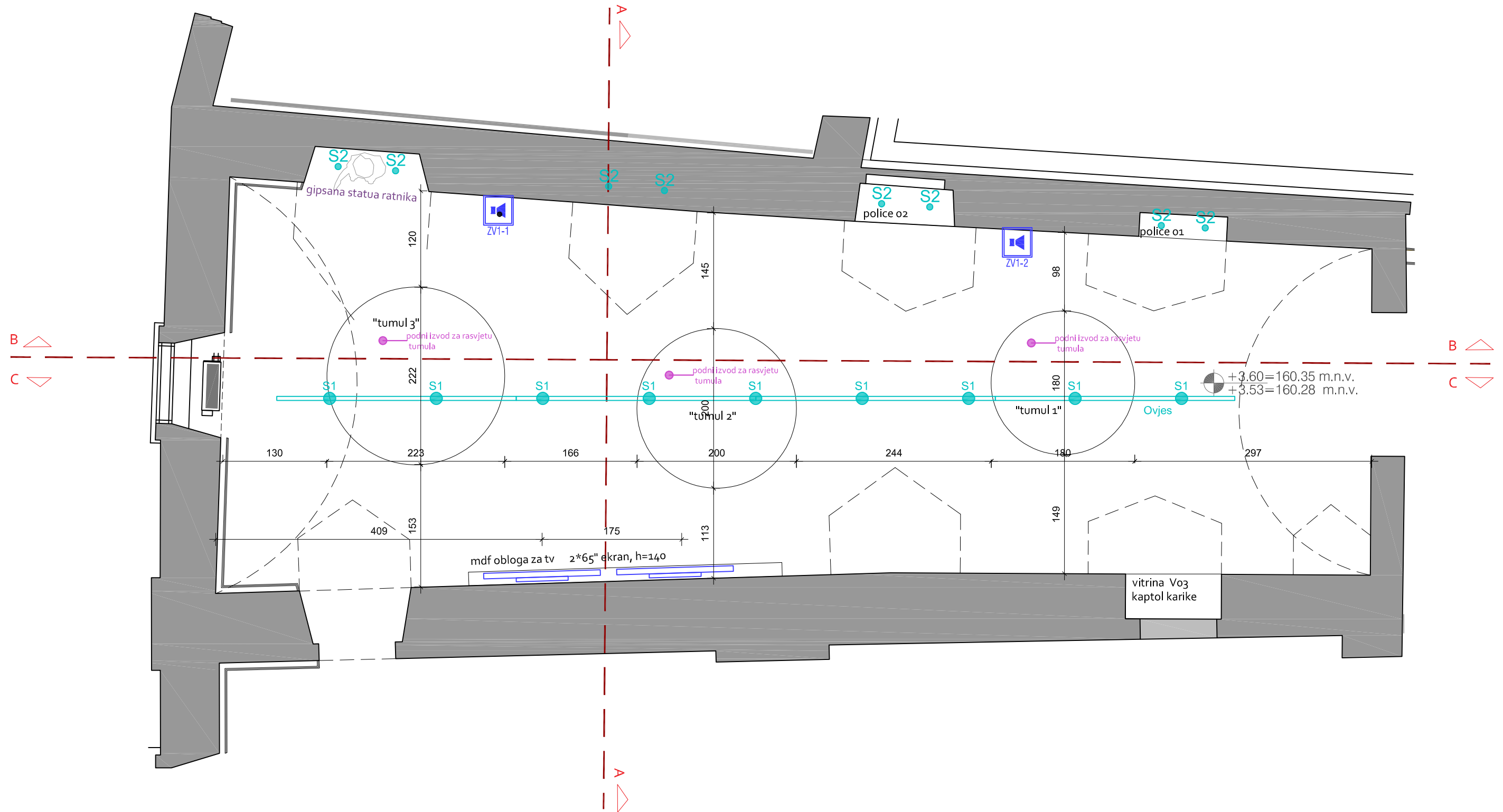

PRESJEK A-A

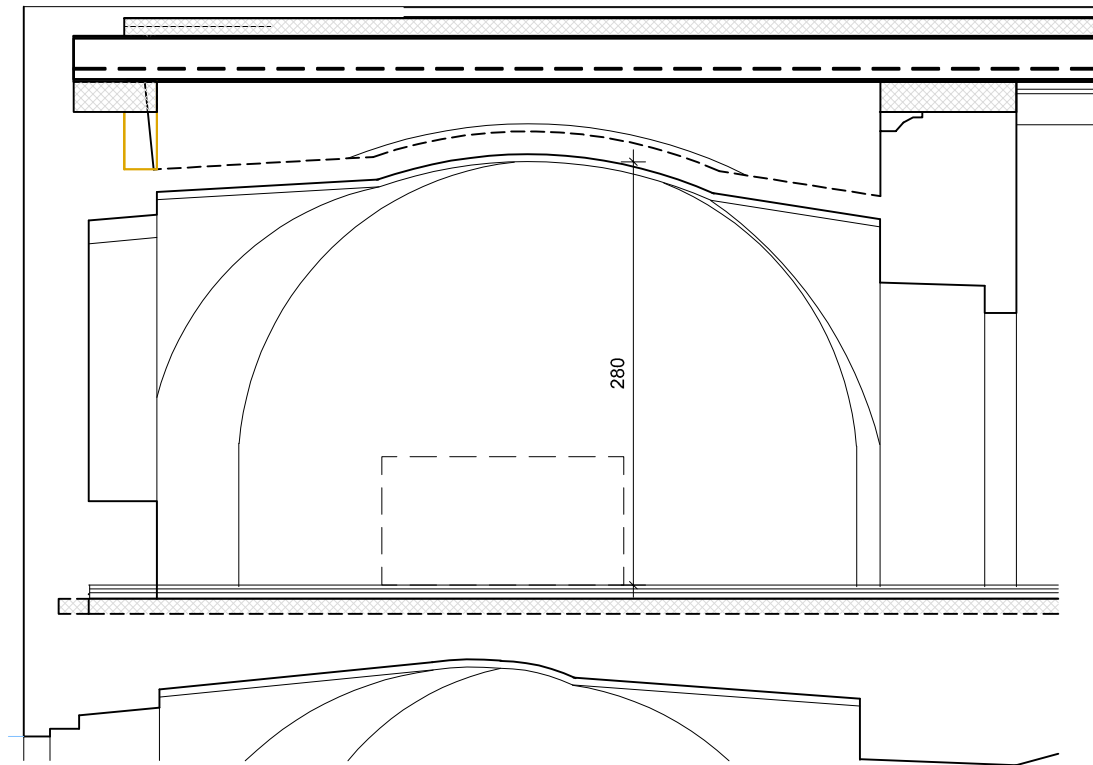

PRESJEK B-B

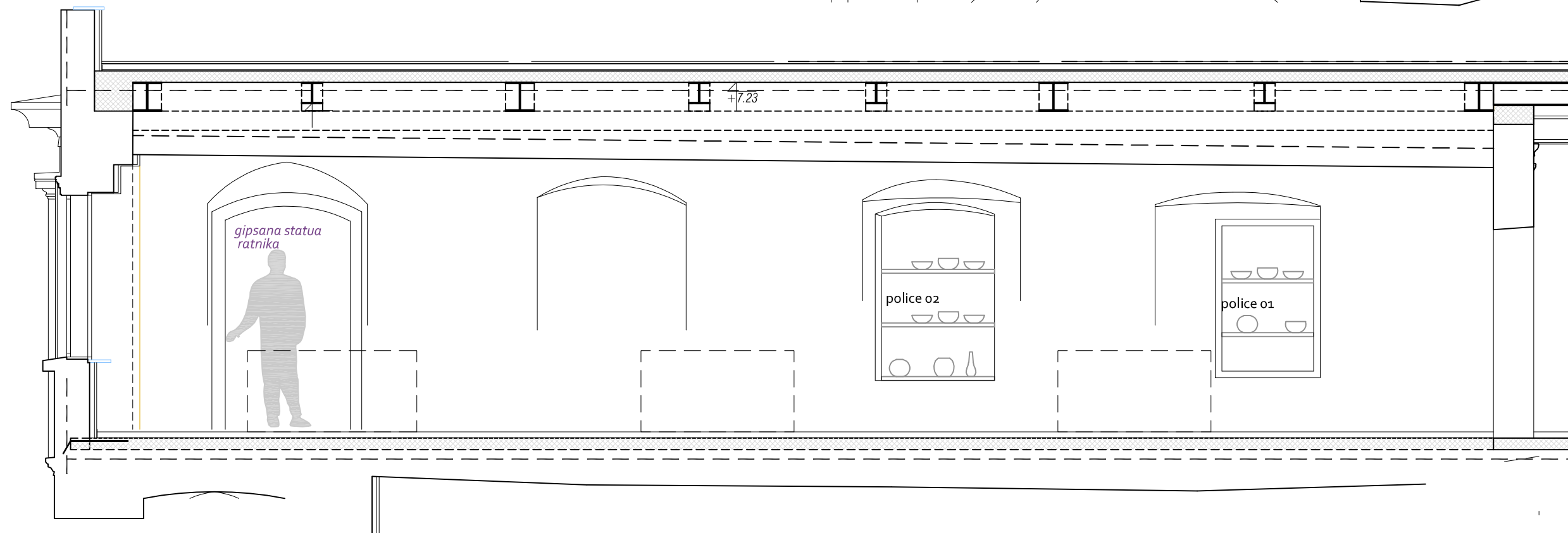

TLOCRT_M1_50_A3

visina svih pregrada 250cm!

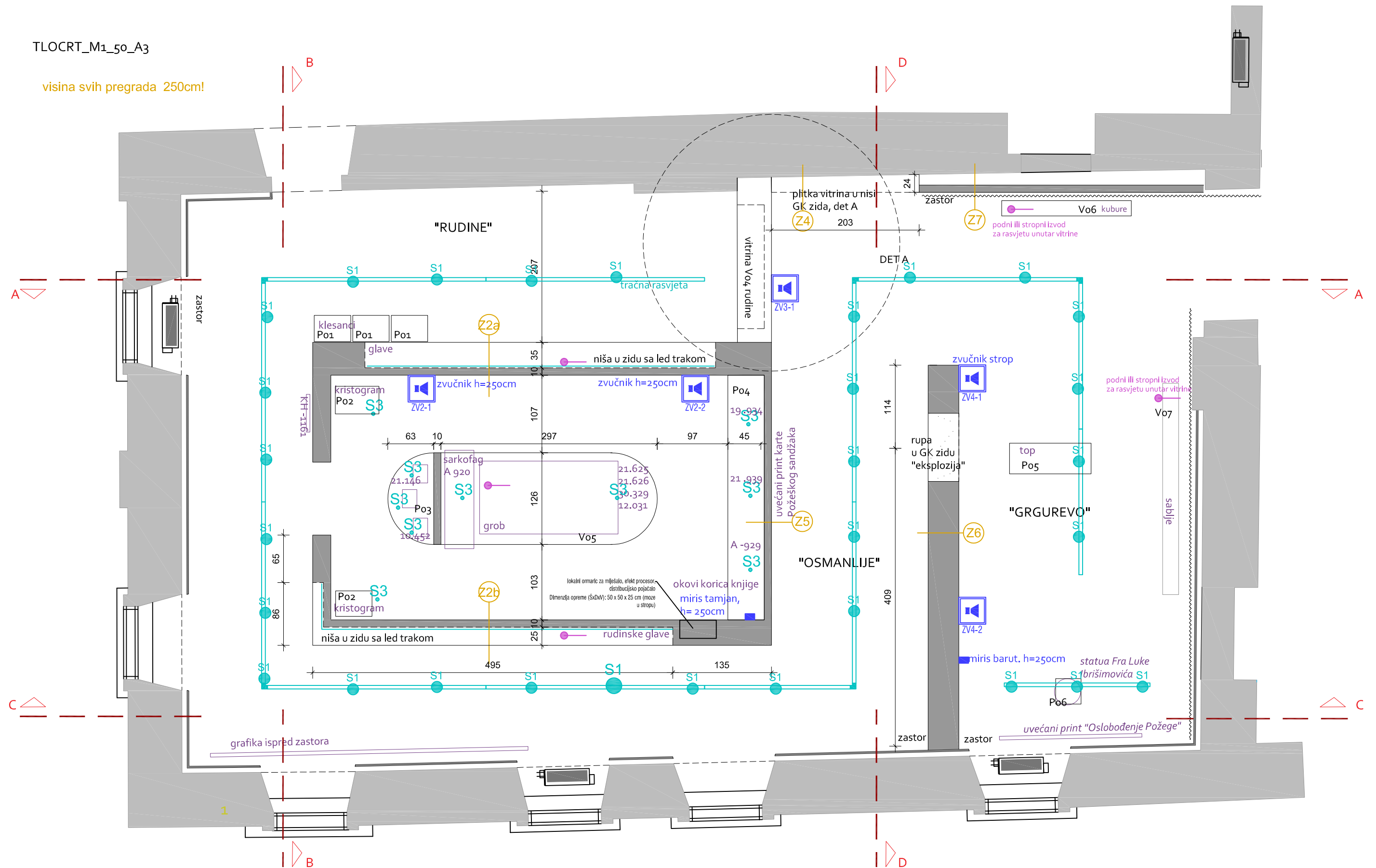

PROJEKT STALNOG POSTAVA GRADSKOG MUZEJA POŽEGA_PRIKAZ POSTAVA PO TEMAMA_Soba 20 "RUDINE, OSMANLIJE"_M1_50_A3



PRESJEK DETALJ A

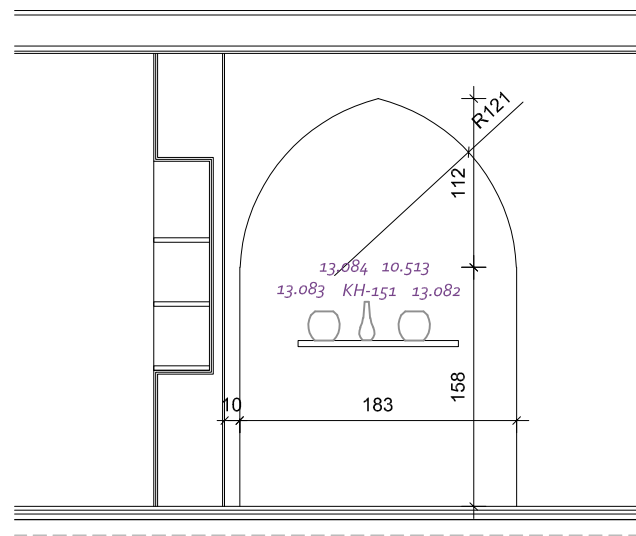

PRESJEK B-B

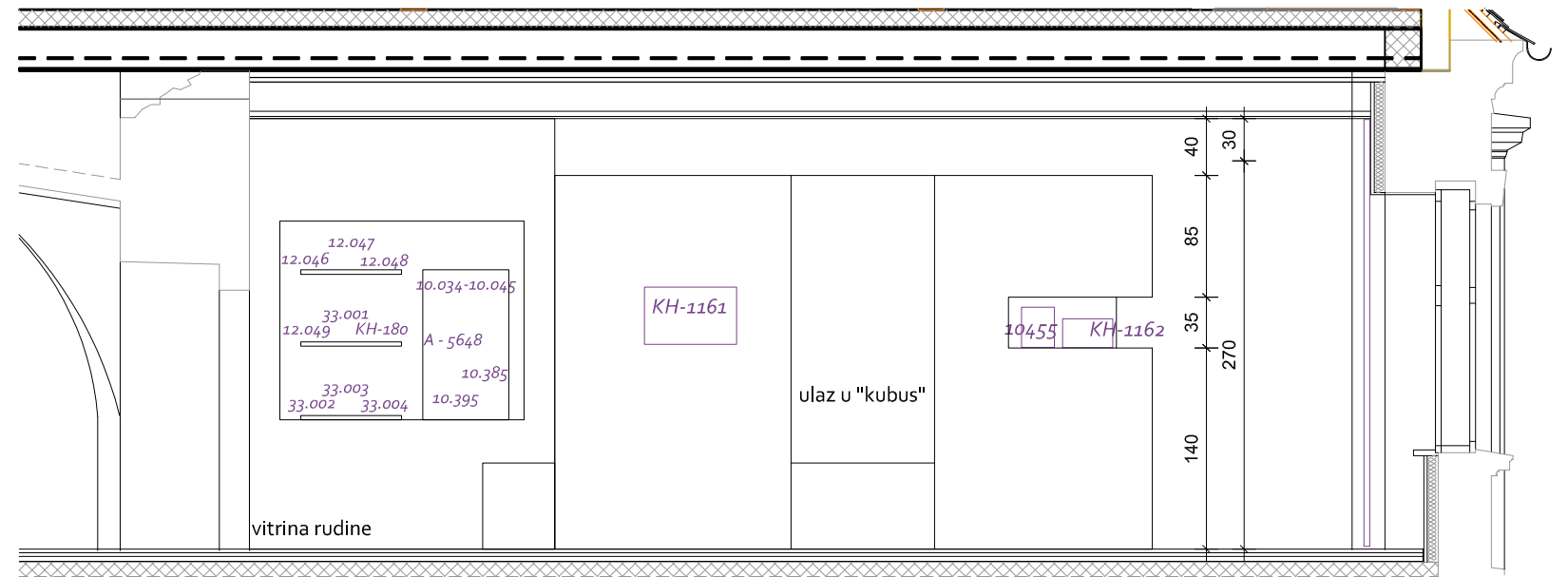

PRESJEK A-A

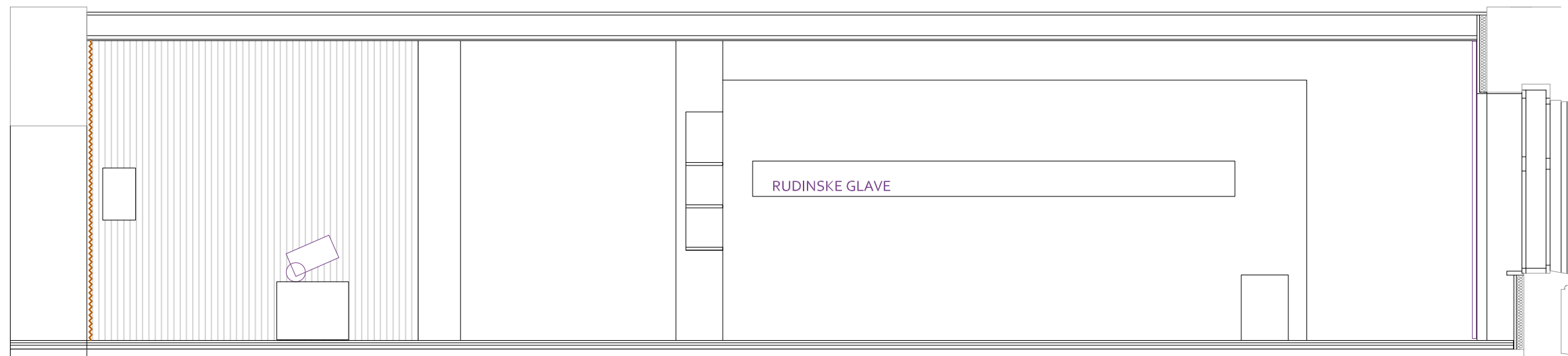

PRESJEK C-C



PRESJEK D-D

ZID Z2A

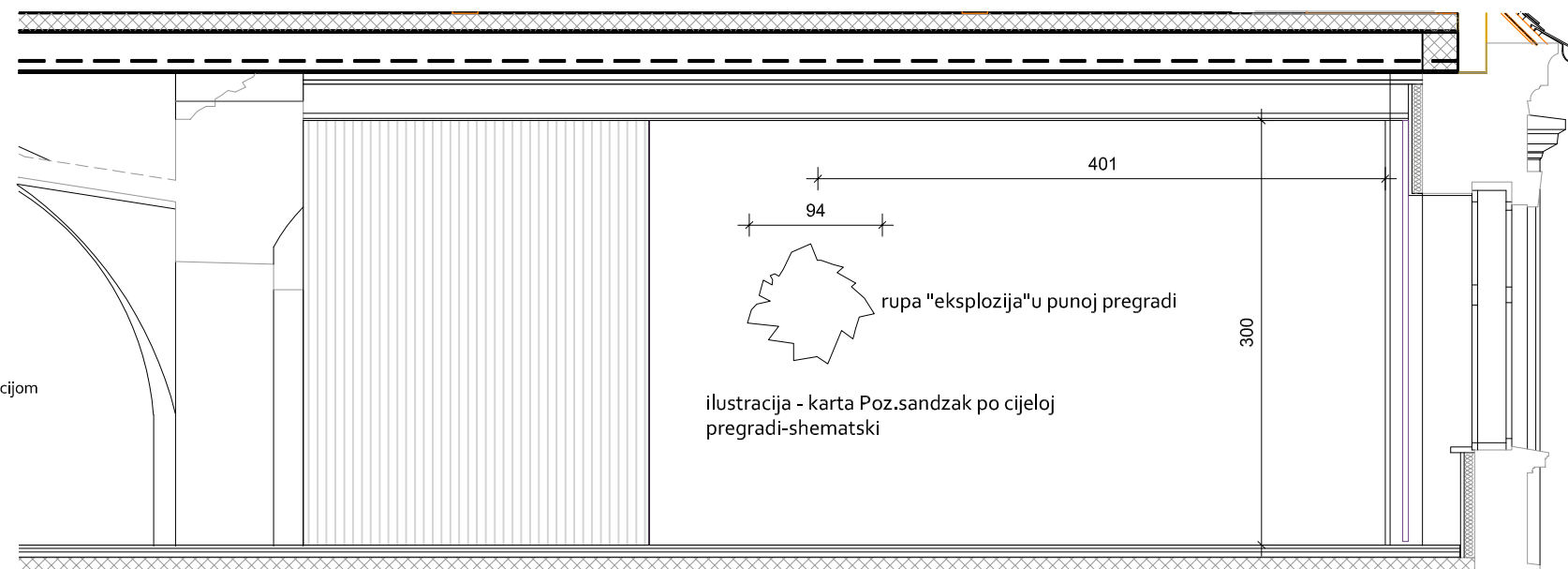
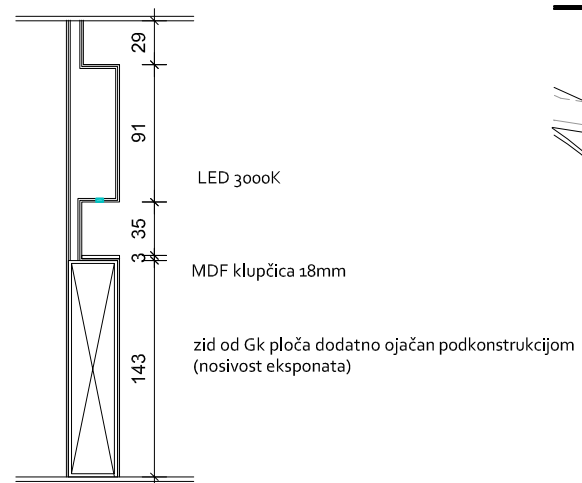



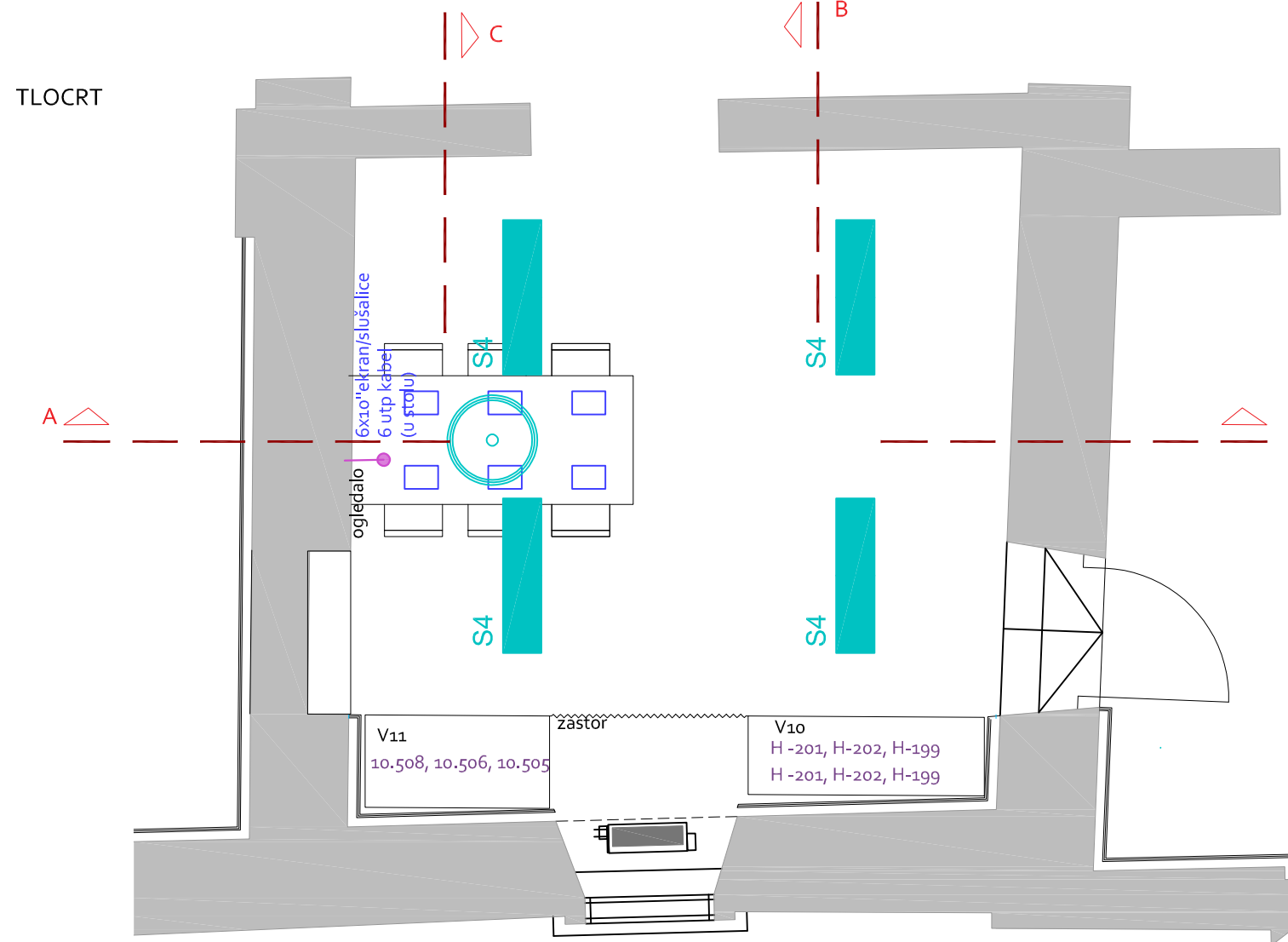

PRESJEK B-B

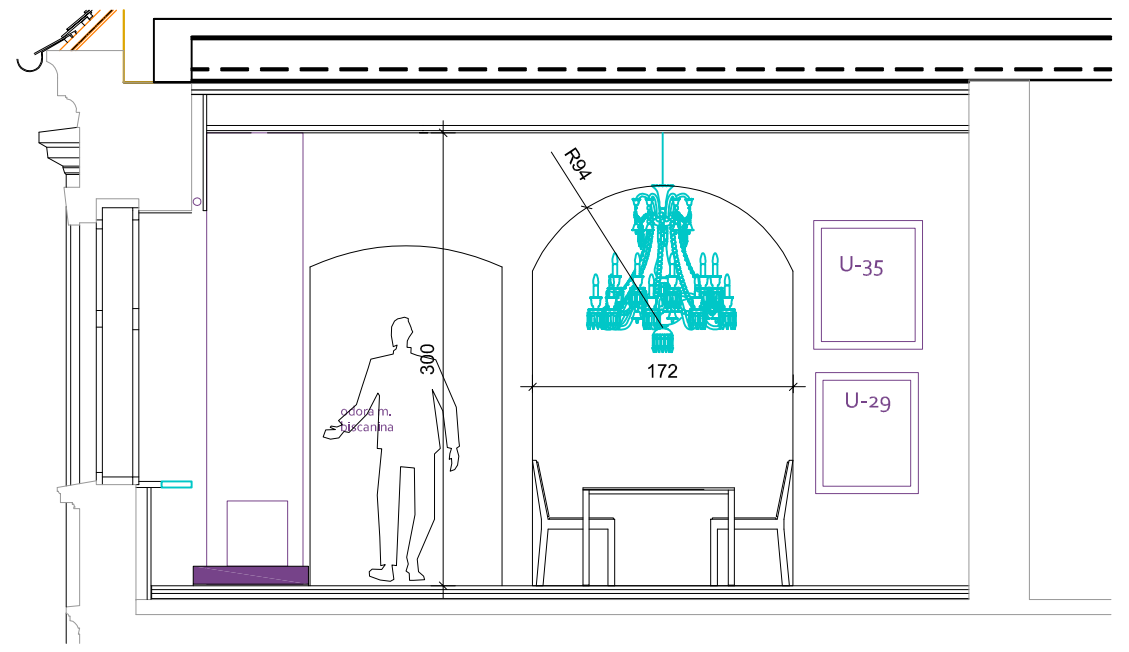

PRESJEK C-C

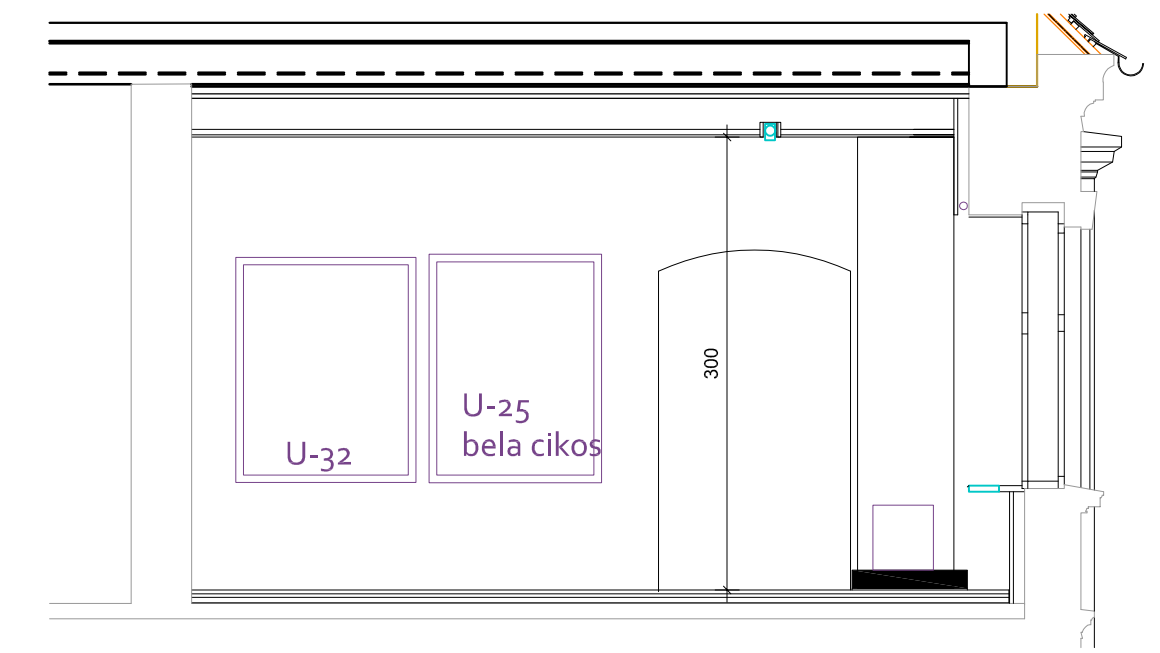

PRESJEK A-A

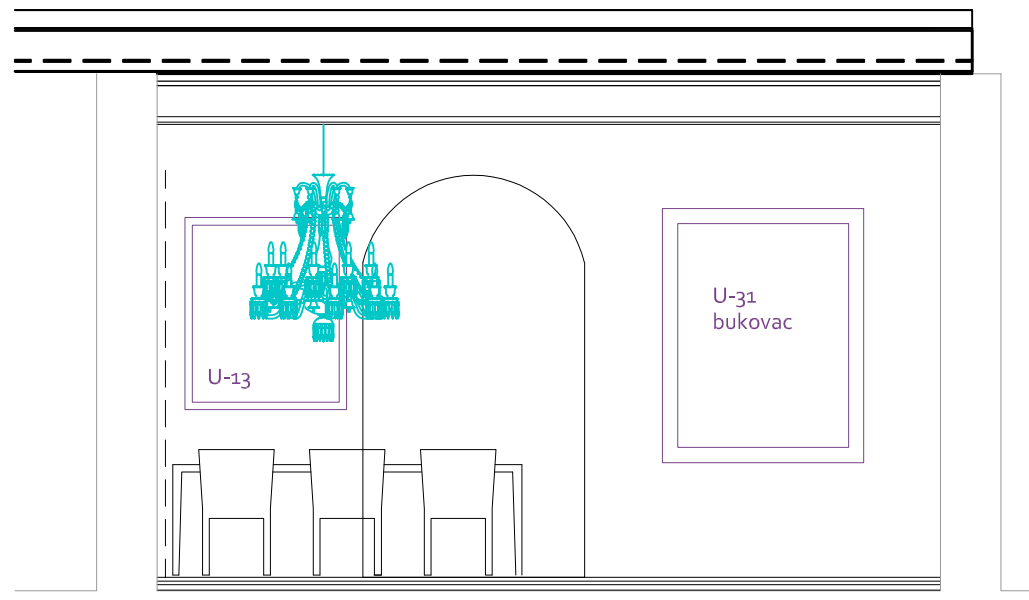

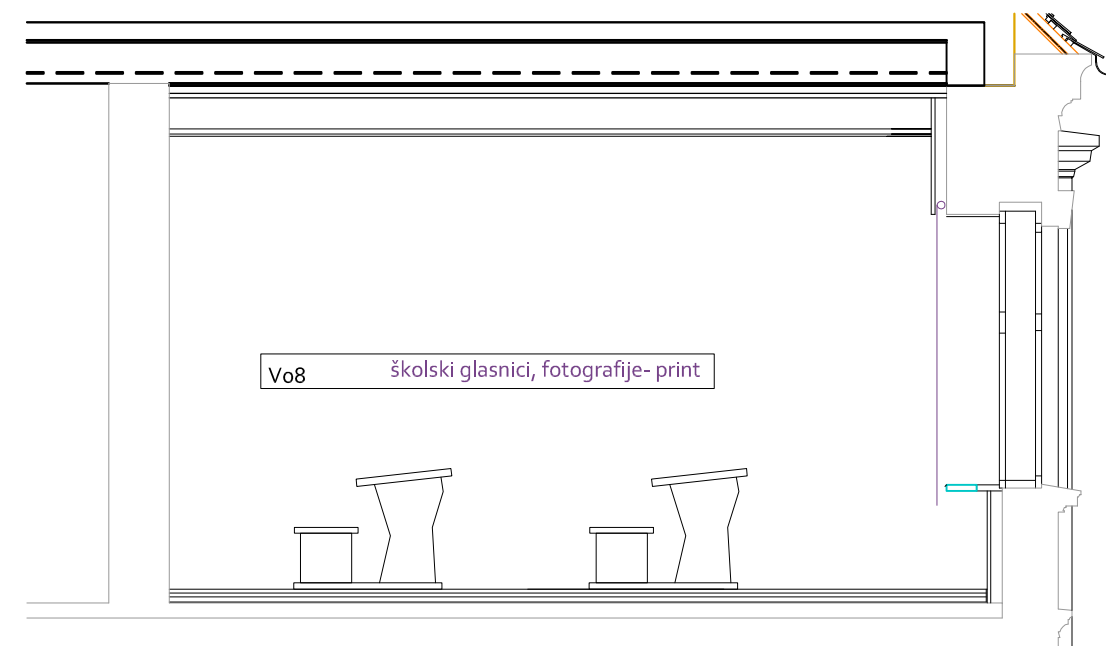
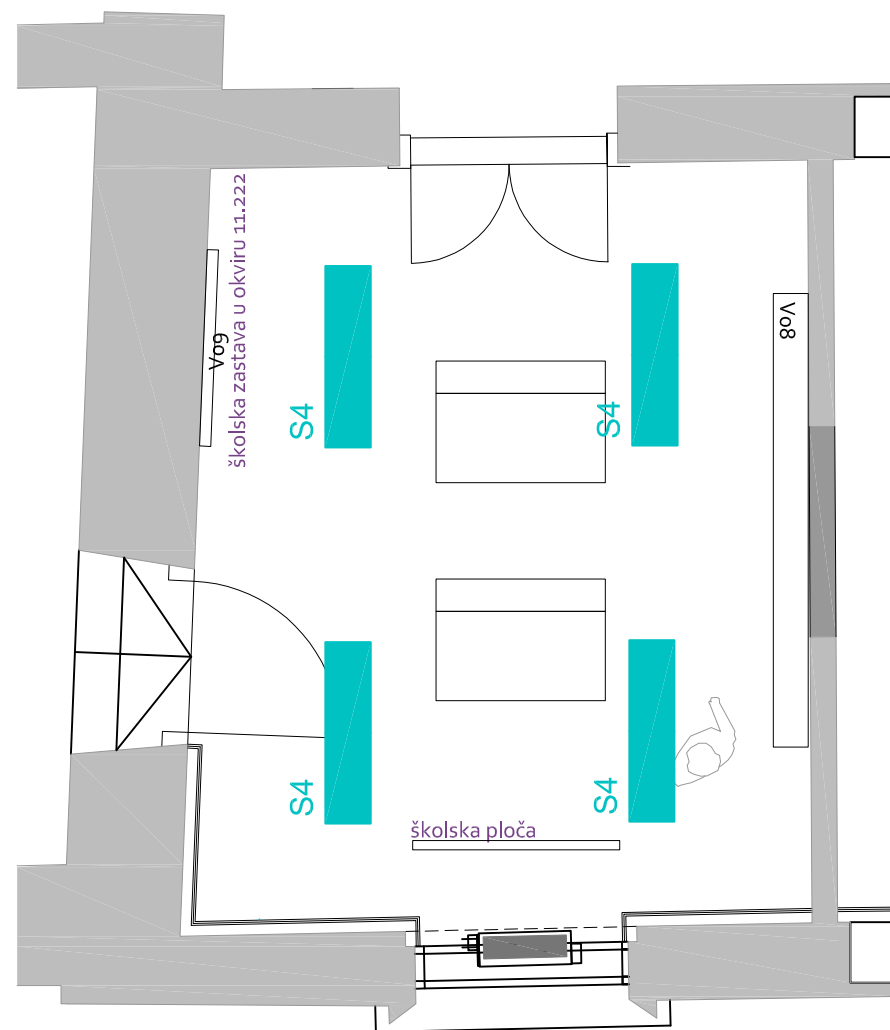

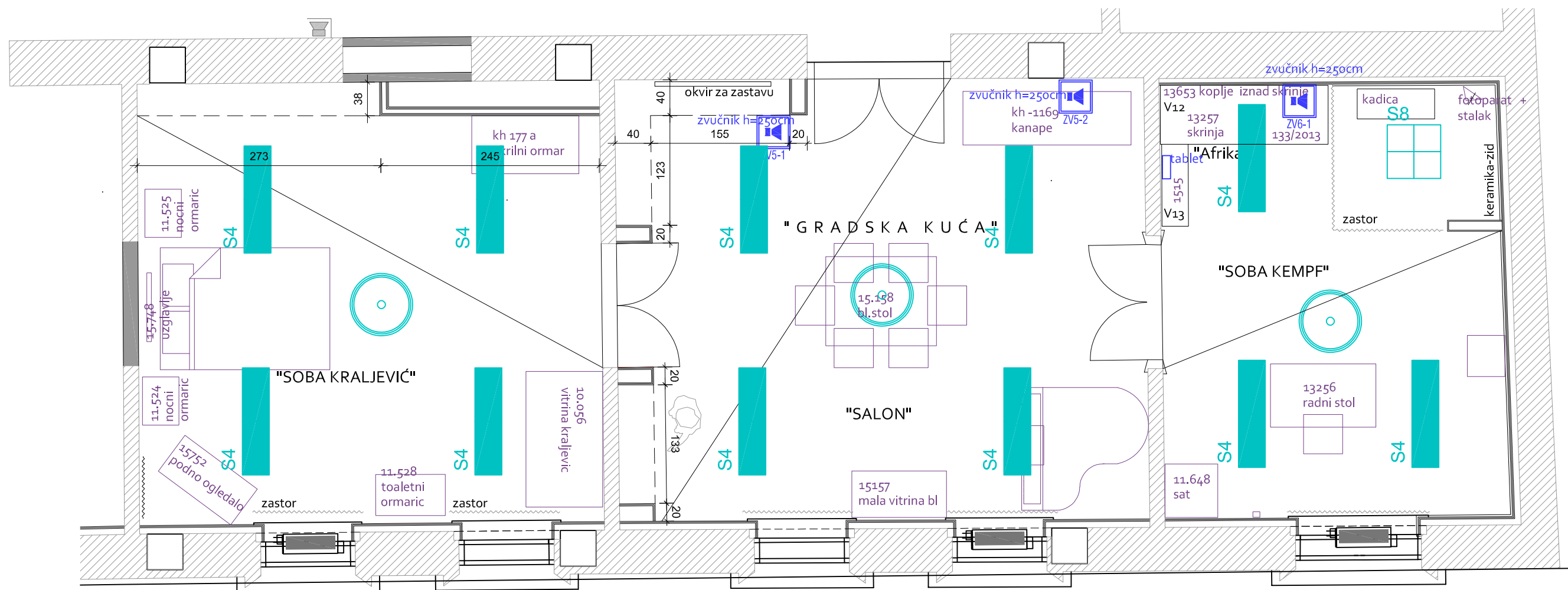

UZDUŽNI PRESJEK

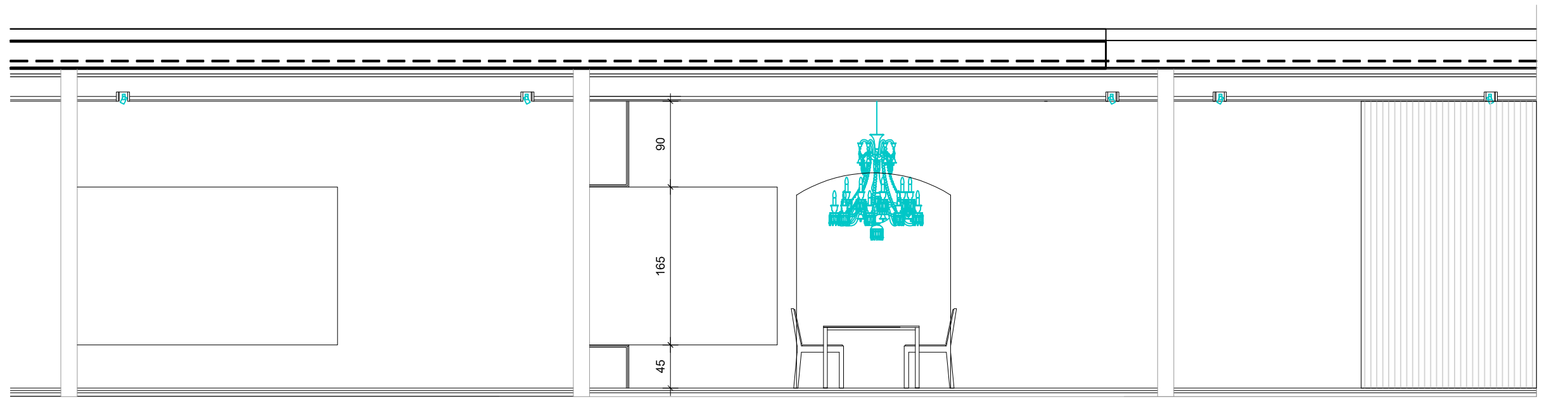



TLOCRT

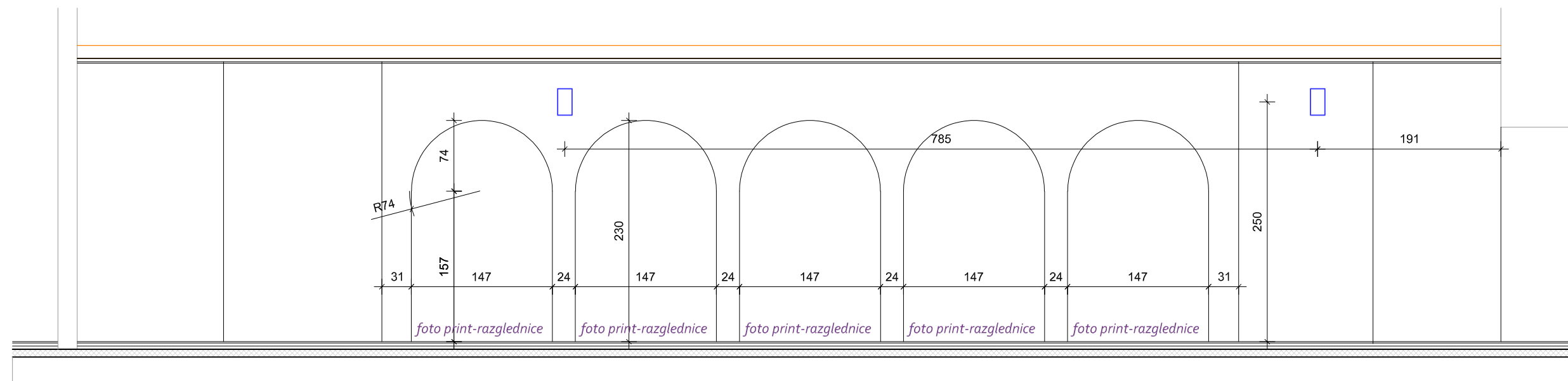
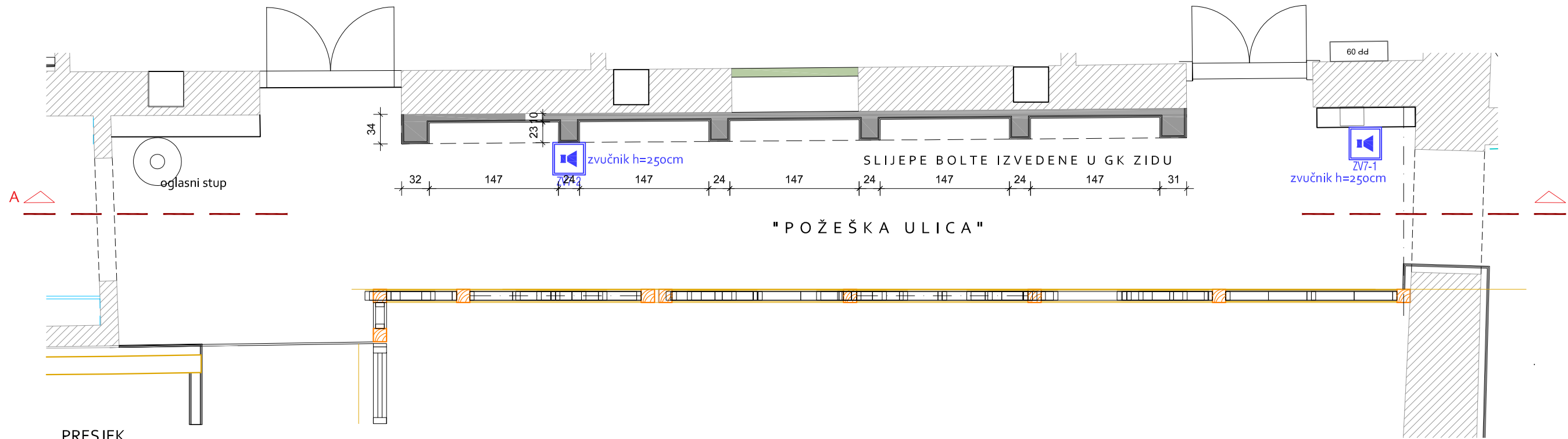

TLOCRT_M1_50_

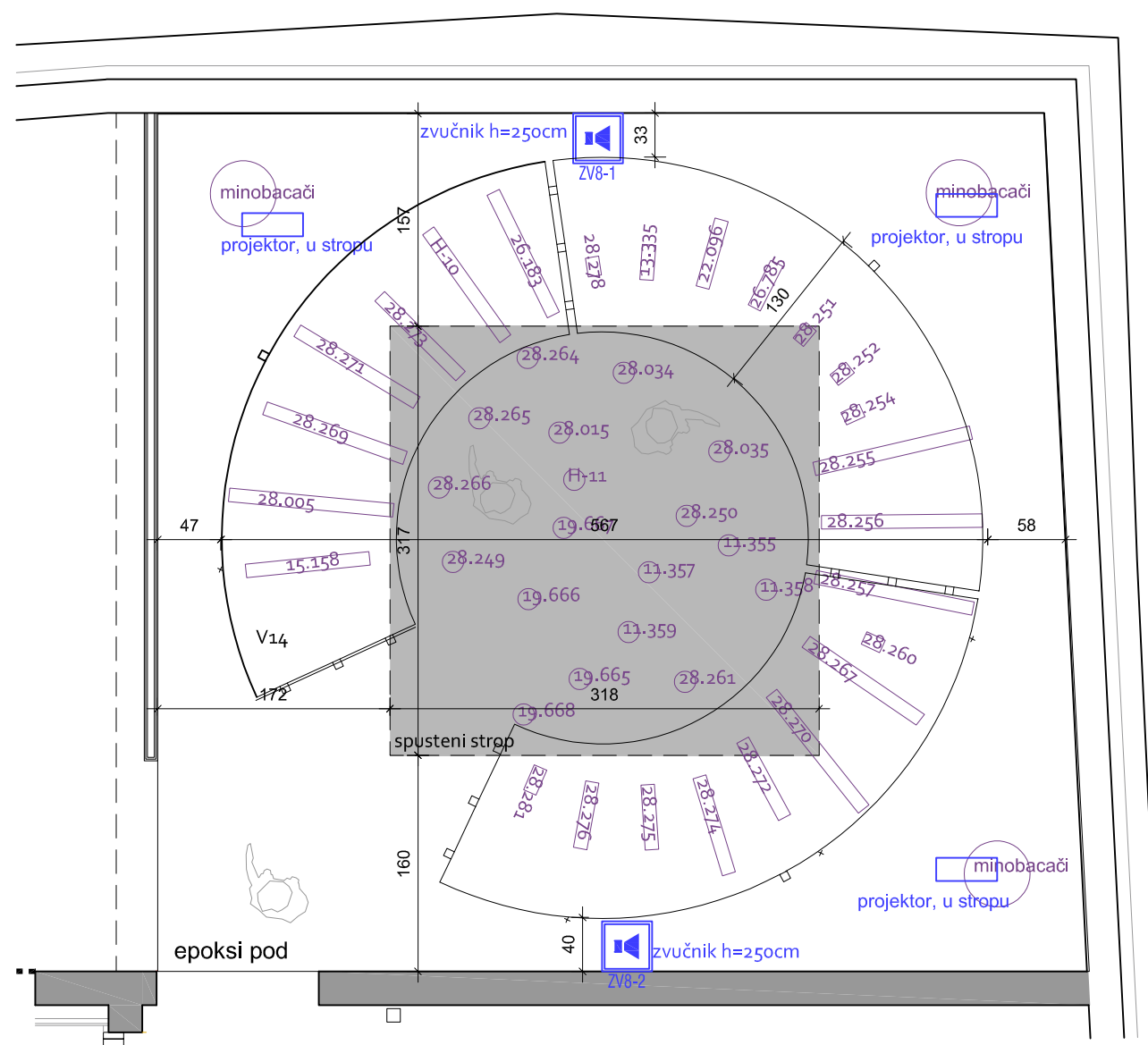

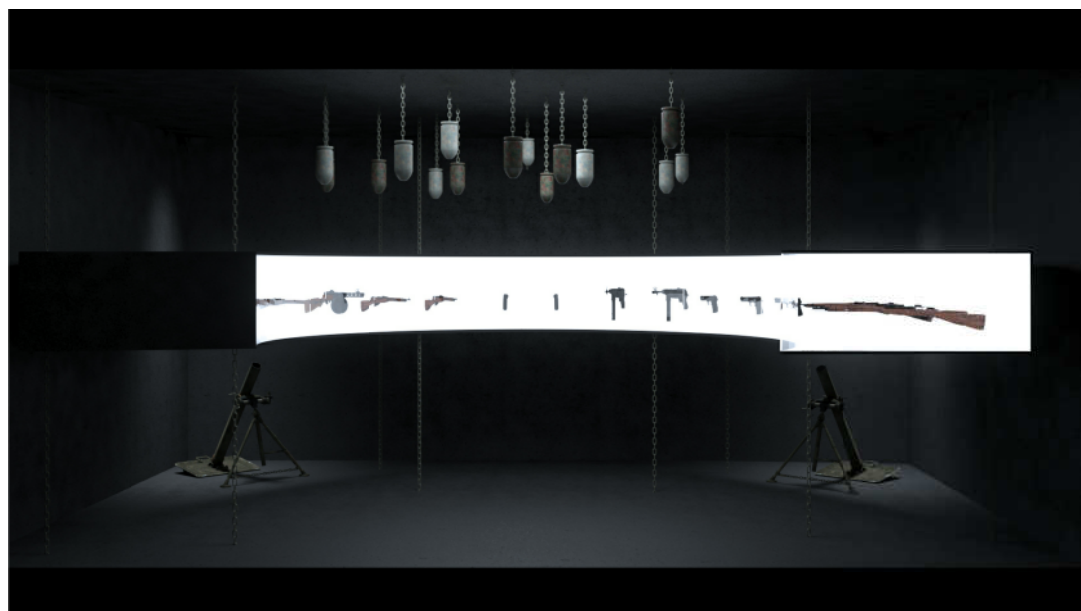

TLOCRT_M1_50_

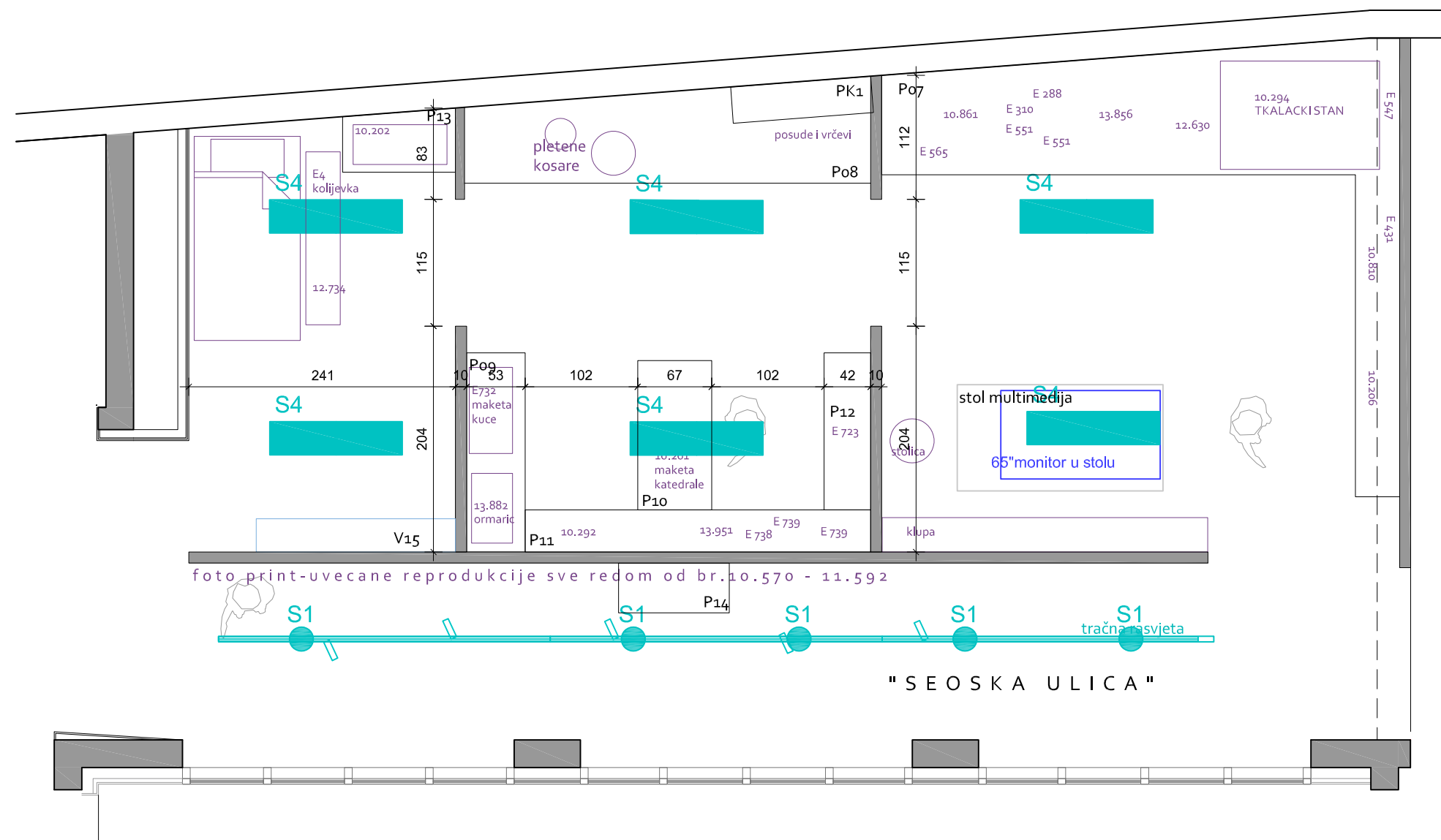

visina svih pregrada 250cm!

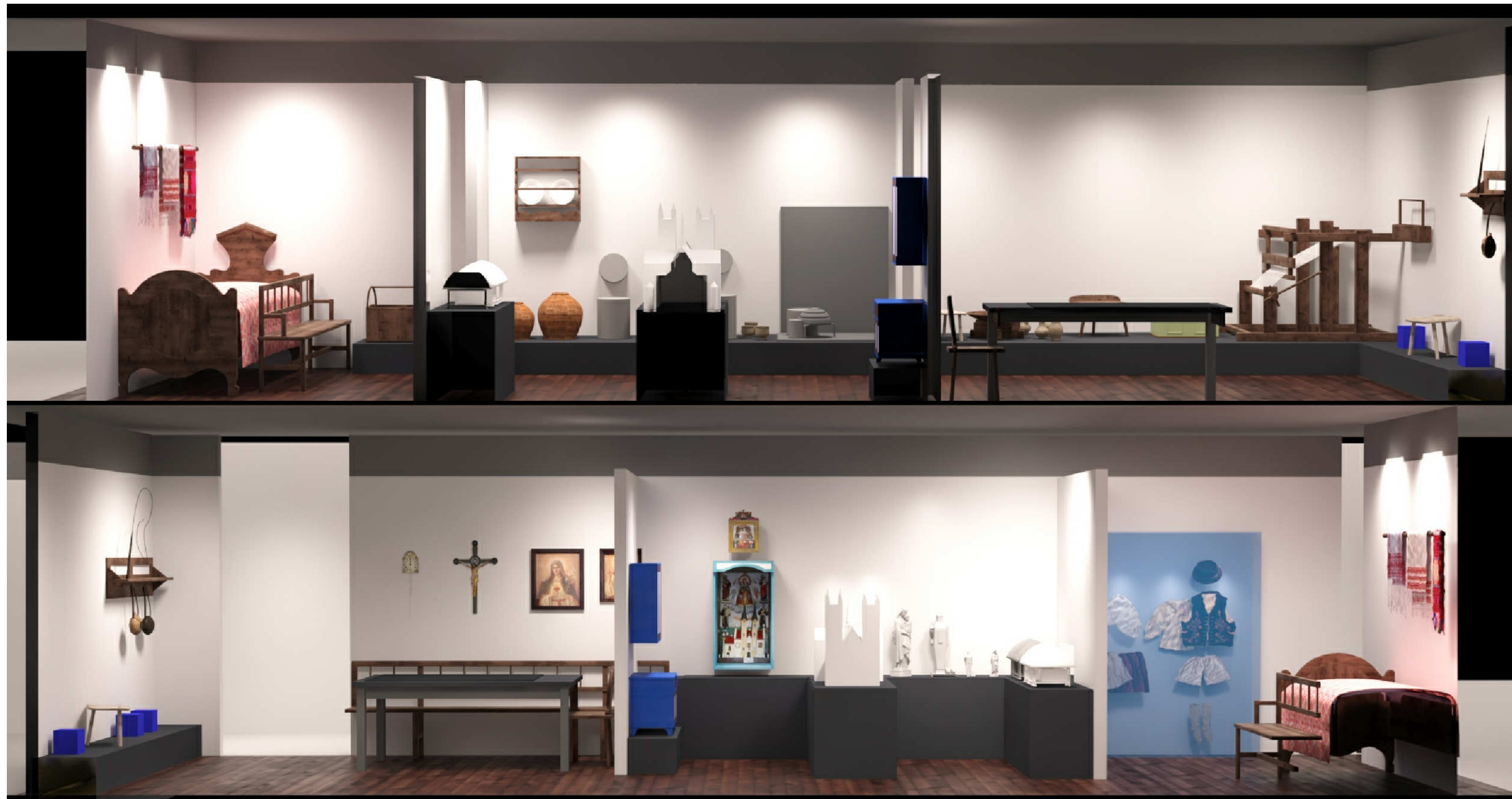

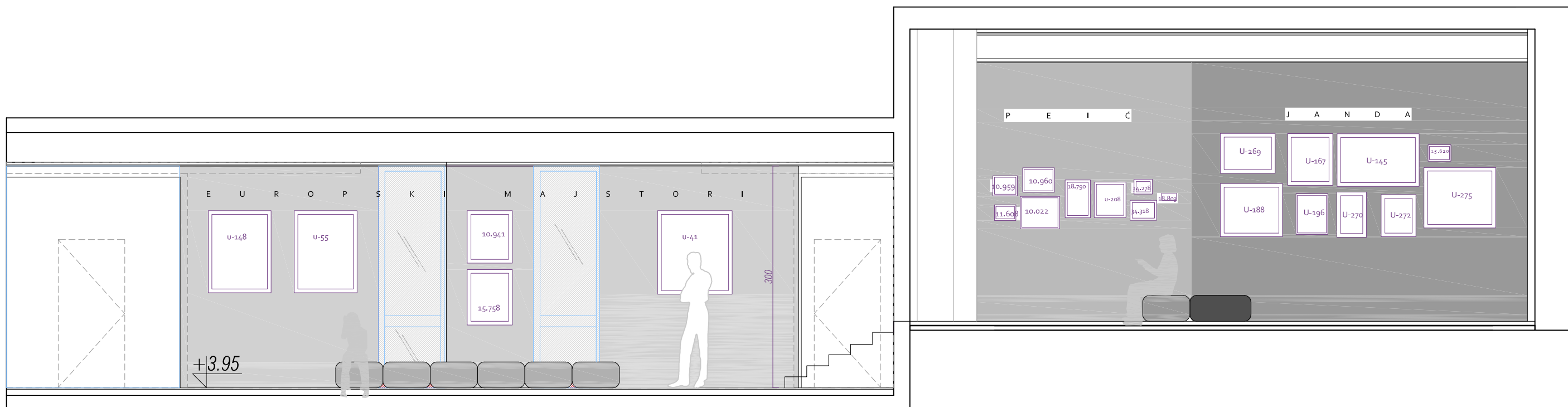
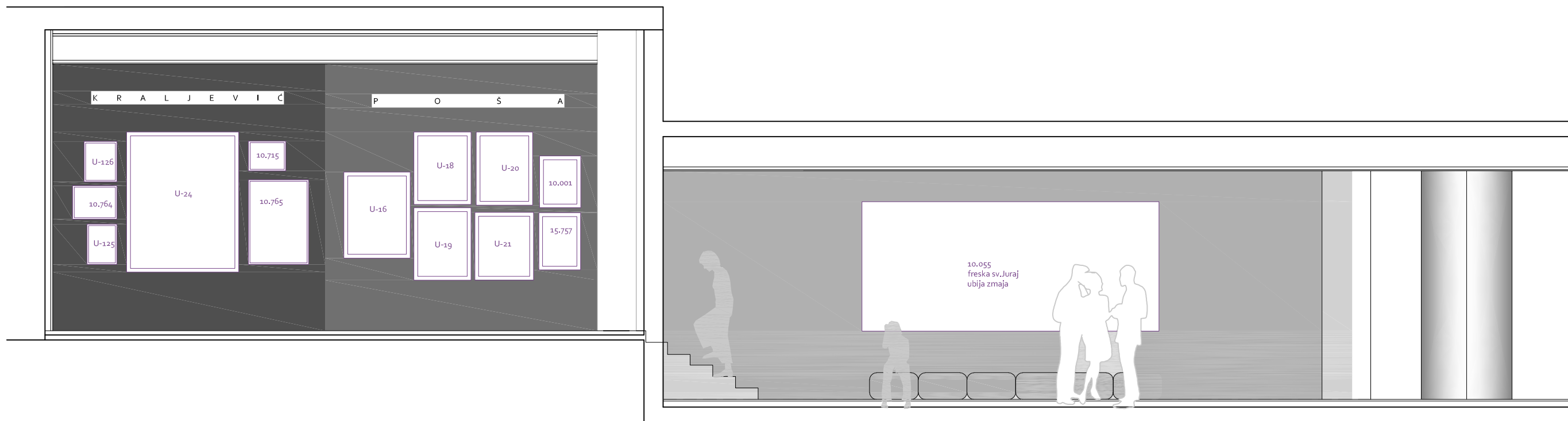

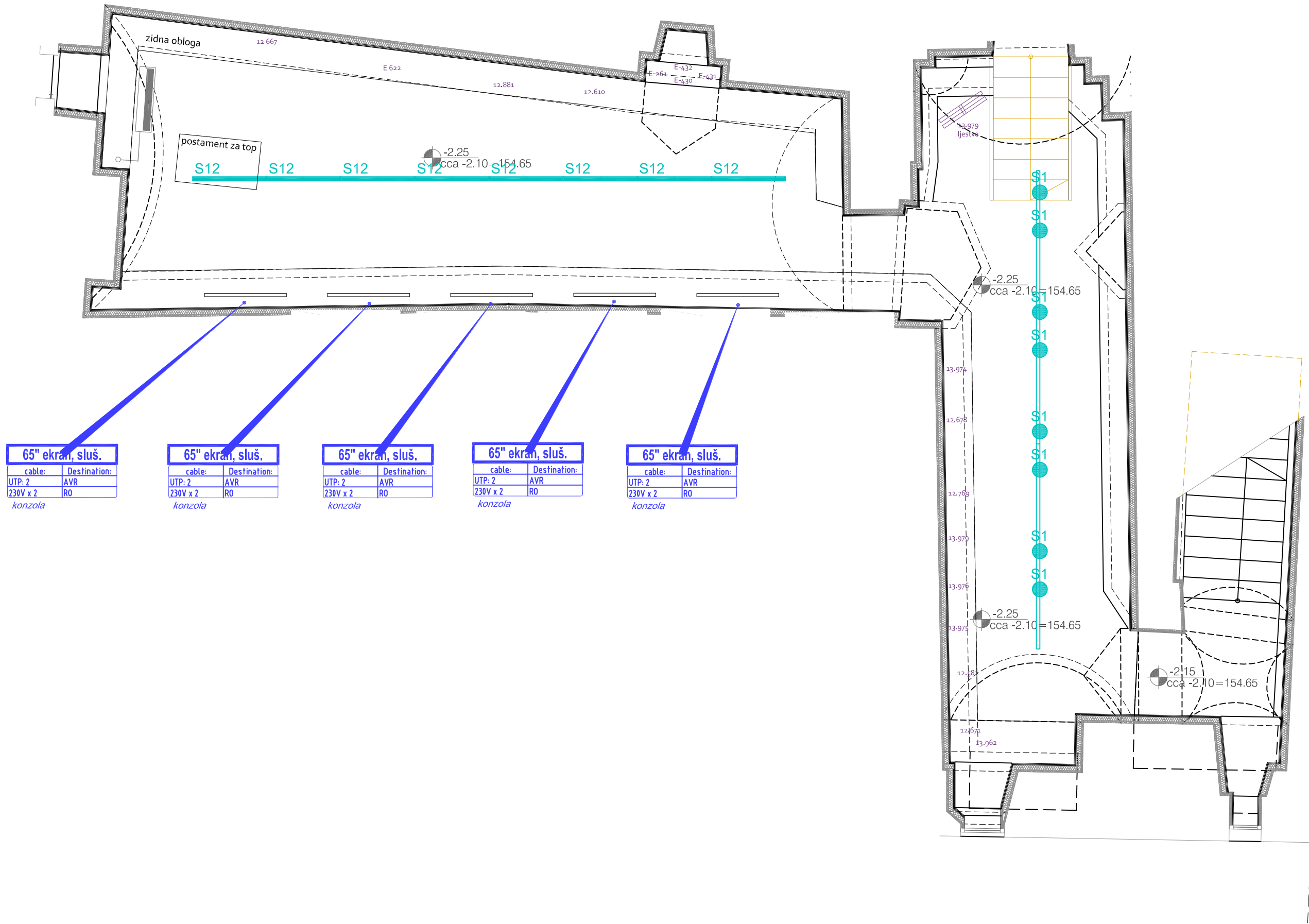

65" ekran, sluš.	
cable:	Destination:
UTP: 2	AVR
230V x 2	RO

konzola

65" ekran, sluš.	
cable:	Destination:
UTP: 2	AVR
230V x 2	RO

konzola

65" ekran, sluš.	
cable:	Destination:
UTP: 2	AVR
230V x 2	RO

konzola

65" ekran, sluš.	
cable:	Destination:
UTP: 2	AVR
230V x 2	RO

konzola

65" ekran, sluš.	
cable:	Destination:
UTP: 2	AVR
230V x 2	RO

konzola

